

2014 UPFITTERS RADIO CONNECTOR

This only applies to vehicles with option code BC3

3D view of connector

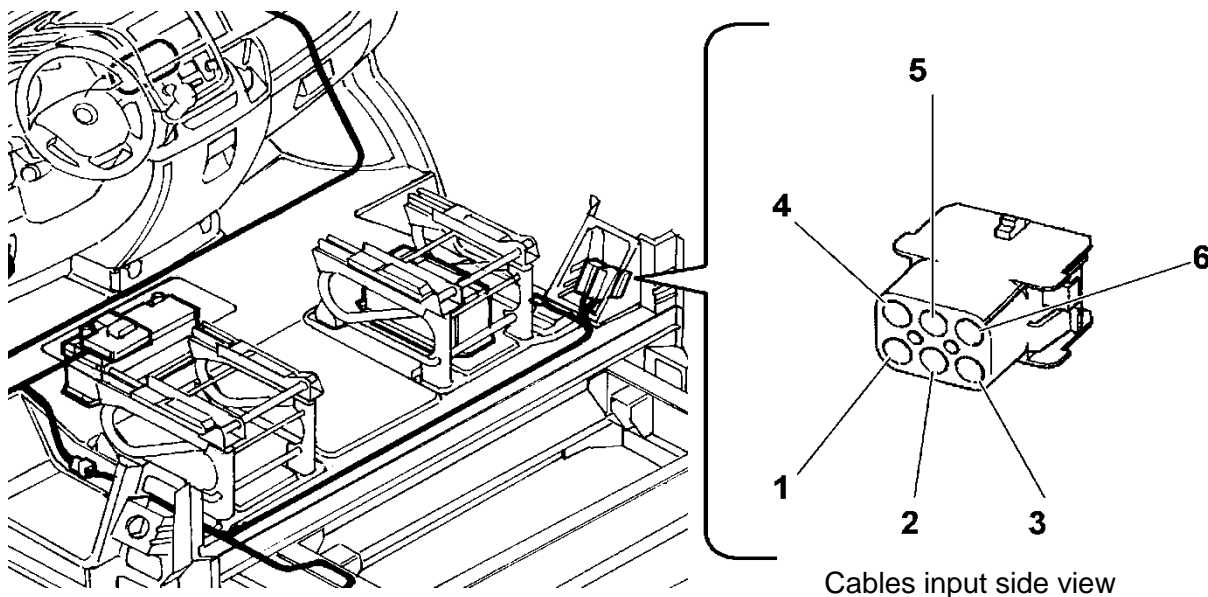

Description of connector functions

Pin	Function/Connector part number	Minimum cable section [mm ²]	cable colour	Notes
	Connector 6-way Tyco p/n 1-480705-0 Mating Connector: Tyco p/n 1-480704-0 (by upfitter)			Reference to diagram C036-L1B
1	Permanent 12V power supply (+30) for radio	1.5	R/Y	Permanent supply from auxiliary battery to radio cable present only from C036-L1A to Y028L1A ⁽¹⁾
2	Rear RH loudspeaker +	1	GR	(2)
3	Rear RH loudspeaker -	1	GR/BK	(2)
4	Rear LH loudspeaker +	1	OR	(2)
5	Rear LH loudspeaker -	1	OR/BK	(2)
6	Not connected	-		

➤ ⁽¹⁾ **NOTE:** the connection from connector Y028L1A to radio is made by the upfitter, who must suitably isolate the radio power supply present in the vehicle main system

2014 UPFITTERS RADIO CONNECTOR

radio power output: 13.4W at 14V
radio drivers: 4 ohm equivalent for each channel
Tweeters: 15W RMS max
Mid-range and Full-range: 20W RMS max

Rear loudspeaker connection

